



Features

- Hydraulic full eject
- Hardox plated bale chamber
- Bale full and pre-full signals
- Hydraulic end door – vertically raised
- Baling wire holdere
- Dual baling pressures
- Bale counter, hour meter
- Anti-jam serrated cutting blades

Optional Extras

- Fast cycle options from 54 – 36 seconds
- Oil cooler
- Bin Tipper for infeed
- Custom hopper design
- Auto start/stop functions
- Paint upgrade – custom colours

Baler Dimensions

Height	2 430mm
Width	1 542mm
Length	6 405mm
Weight	7.25T
Feed Opening	1 350mm x 1 050mm

Bale Dimensions

Height	750mm
Width	1 100mm
Length	1 450mm
Weight (material dependent)	up to 550kg
Number of ties	4

Performance

Power Suplpy	415 V 3-Phase
Motor	11kW 40A
Pressing Force	50T
Cycle Time	54 seconds

[More product info on our website >>](#)



Dimensions and technical information without obligation. Subject to change.

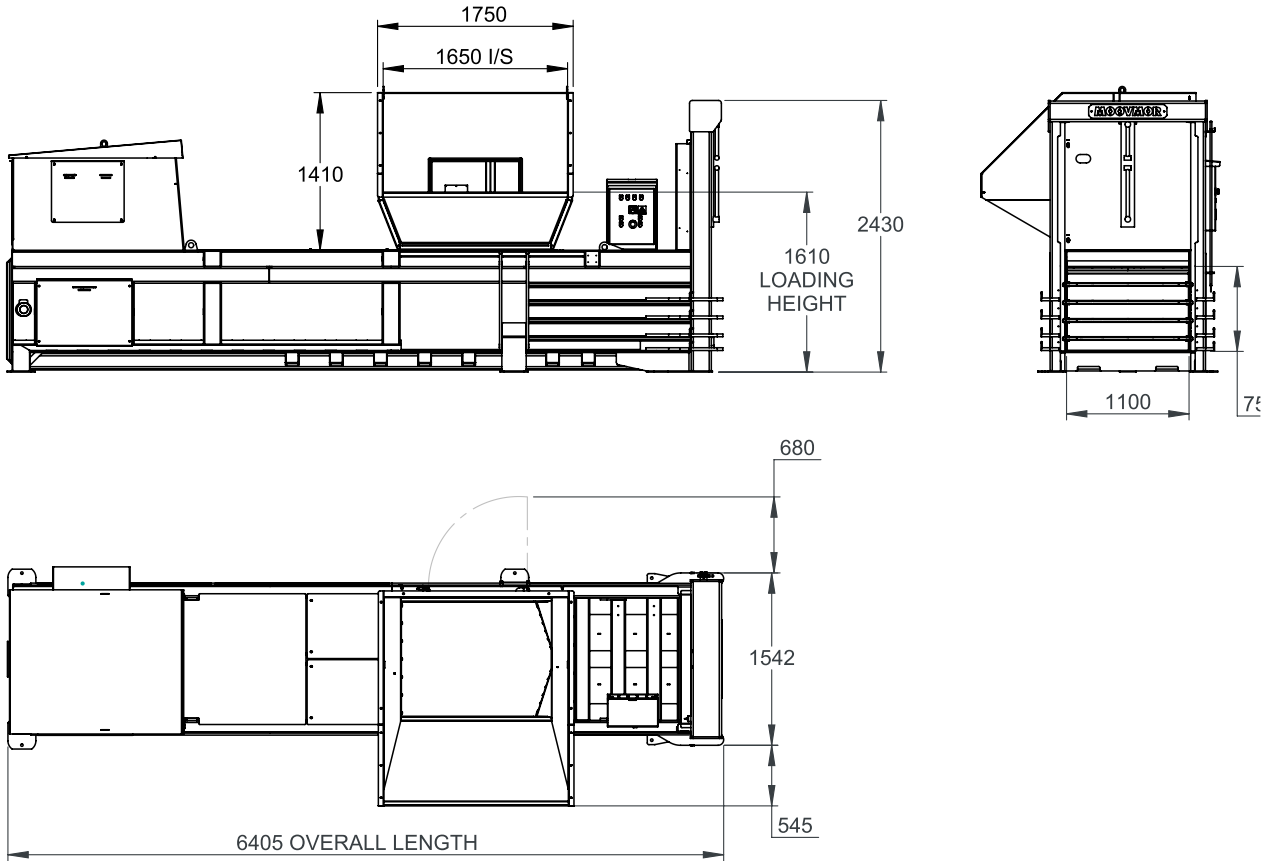

Size Comparison



Bale Weight
Up to 550 Kg



Pressing Force
Up to 50 Ton

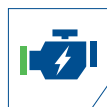

Motor
11kW 40A



Waste Types
Cardboard,
General Waste &
Processed Food

